



**TYPICAL UNIT PLAN
1 BHK OPTIMA**



**TYPICAL UNIT PLAN
1 BHK ULTIMA**



LOCATION HIGHLIGHTS



5 mins walk to proposed Pendhar metro station



10 mins drive to Central Park



10 mins drive to Golf Course, Kharghar



10 mins drive to Taloje railway station

A project by



A signature of trust

SIDDHIVINAYAK RIDDHIMA

Site: Survey No. 1/1/7, 1/8/B & 1/9, Koynavele, Taloje, Navi Mumbai.
Corporate Address: Plot No.35, Opp. To Ganesh Mandir, Sector - 5, Kharghar, Navi Mumbai - 410 210
Email: info@siddhivinayakhomes.co.in

Call: 96999 00600

Disclaimer : The information, specification, amenities, layout, pictures etc. shown/contained in this brochure are indicative only . The Builder/Developer shall not be liable, responsible, obligated and/or required to provide any/all such amenities, specifications etc. as contained in this brochure. All plans, drawings, information, specification, amenities etc. are subject to approval from local government authorities & Municipal Corporation. The Builder/Developer shall have irrevocable and unconditional right to change, delete, substitute, alter, subtract, add, amend etc. the said plans, drawings, information, specifications, amenities, layout etc. in such manner as the Builder/Developer may deem fit. No right of nature whatsoever shall be constructed and/or deemed to have accrued in favour of any person and/or purchaser of the premises from or by virtue of this brochure. The Builder/Developer shall not be liable and/or responsible for any loss, damages, cost, expenses suffered /incurred and/or likely to be suffered and/or incurred by any person and/or purchasers of the premises. No person or purchaser of the premises shall have any right to be entitled claim or enforce any right based on this brochure.



Come home to
A PERFECT BLEND of
CONNECTIVITY,
LUXURY and
AFFORDABILITY.

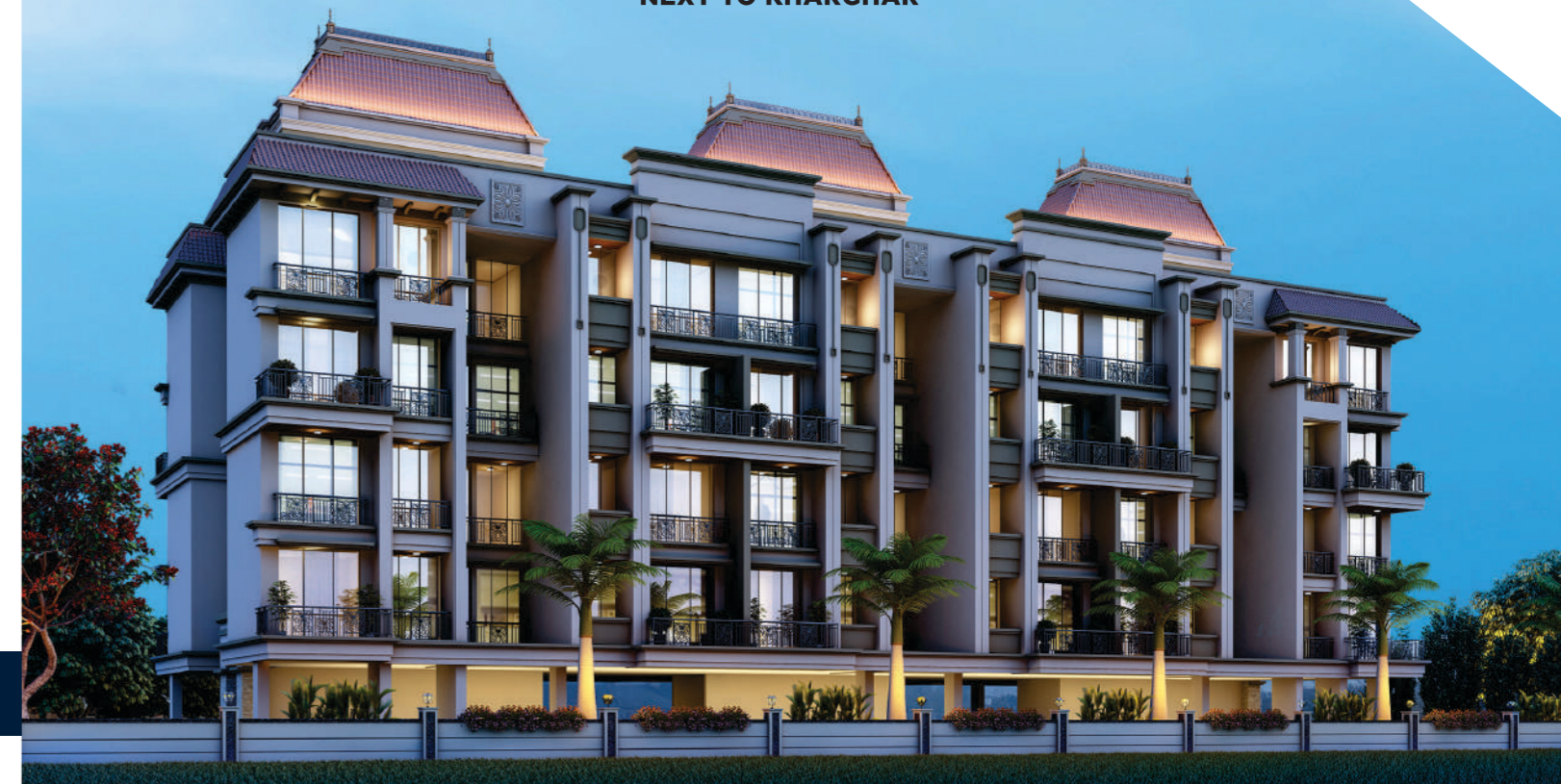

Near Proposed Pendhar Metro Station

The project has been registered via MAHARERA Registration Number P52000018157 and is available on the website <https://maharera.mahaonline.gov.in> under registered projects.



Located in the heart of all connectivity points that matter, Siddhivinayak Riddhima is a dream home come true. Be it the proposed Pendhar metro station, Central Park, Kharghar Golf Course or Tajola railway station – reach these touchpoints within minutes from your home. Designed with thoughtful aesthetics and luxurious amenities, Siddhivinayak Riddhima comes at an unbelievable price that's well within your reach as well. An ideal blend of luxury, connectivity and affordability that's hard to find in today's pricey real estate scenario. Come, save time on travelling and spend ample quality time with your family. It doesn't get better than this!

KEY PROJECT HIGHLIGHTS

Gym



Kids Play Area



Garden



Club House



images are for representational purpose only

MASTER PLAN LAYOUT



TYPICAL UNIT PLAN 2 BHK OPTIMA

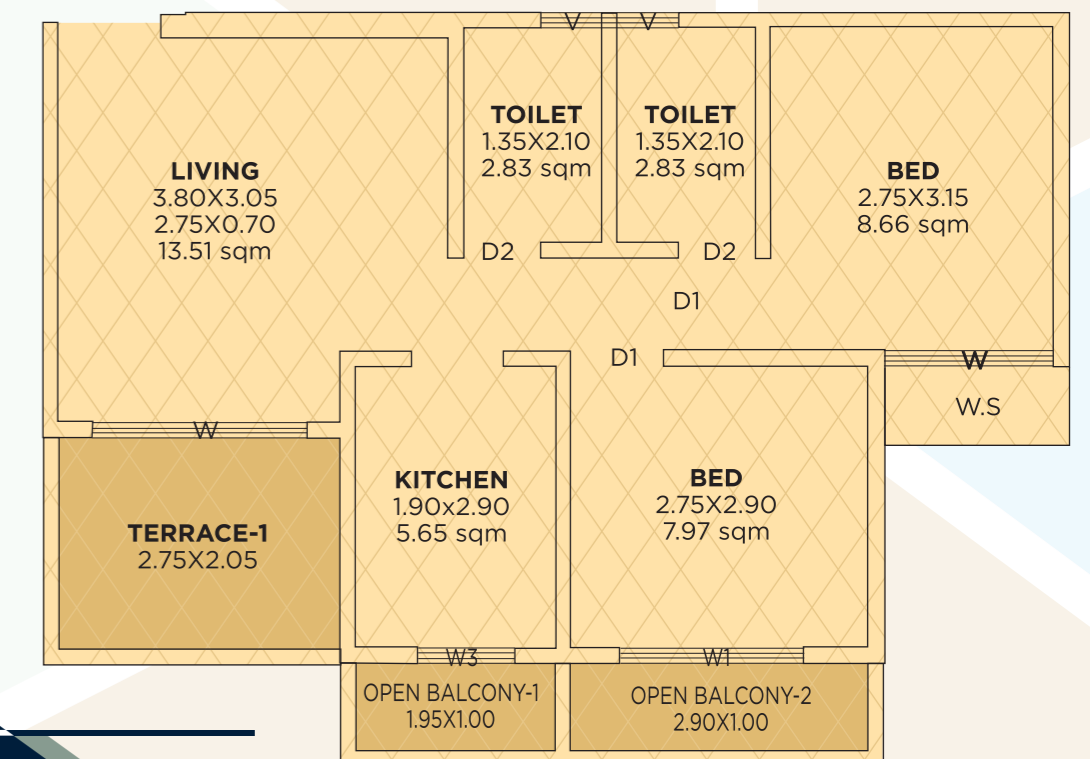
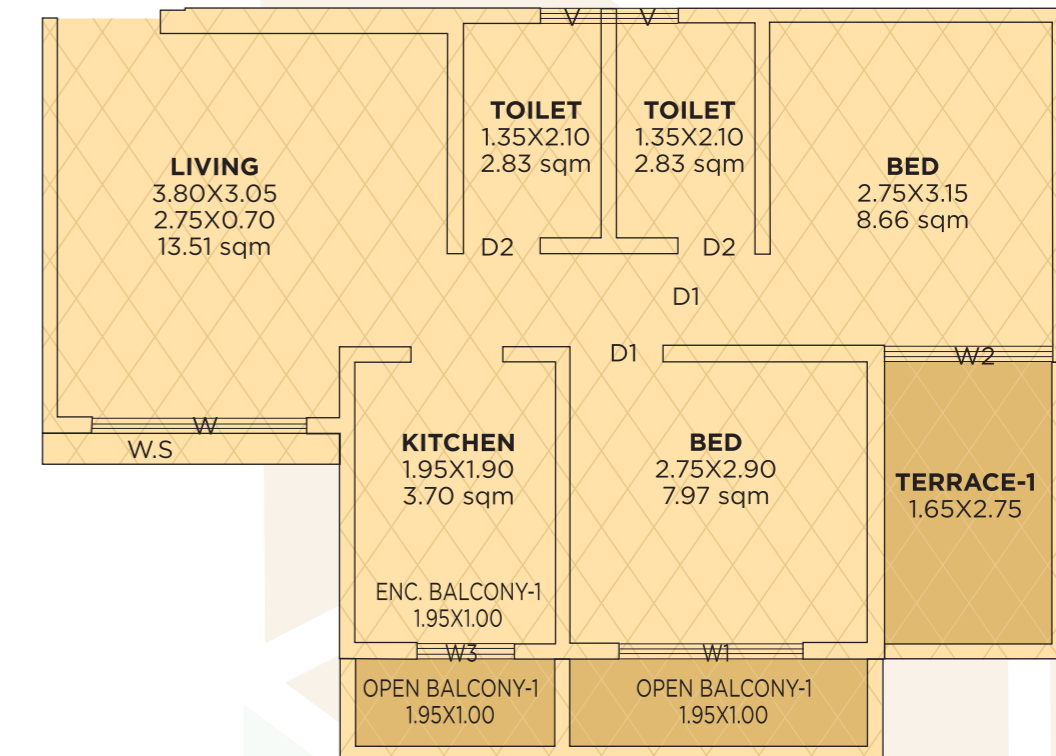

TYPICAL UNIT PLAN 2 BHK ULTIMA