

LET LIFE GET WINGS



# KUKREJA CLASSIC

OFF PALM BEACH ROAD, SANPADA



STRATEGIC PARTNER:  
**ANAROCK**  
VALUES OVER VALUE

MahaRERA Registration No. A51900000108  
Available at [Maharera.mahaonline.gov.in](http://Maharera.mahaonline.gov.in)

Site Address: Sector 16, Sanpada, Navi Mumbai - 400 705. | [www.kukrejaconstructions.com](http://www.kukrejaconstructions.com)

MahaRERA Registration No. P51700017947 | available at [Maharera.mahaonline.gov.in](http://Maharera.mahaonline.gov.in)

Disclaimer: This is not an offer, an invitation to offer and /or commitment of any nature. The images and/or content and other details herein are only indicative in nature & do not form the part of the standard specifications/ amenities/ services to be provided in the flat. All specifications (area, floor plans, etc.) of the flat/ project shall be as per the final agreement between the concerned Parties. Recipients are advised to use their discretion in relying on the information/ amenities described/ shown herein.

thoughttrains



WHY WALK  
WHEN YOU CAN FLY?

WHEN YOU WERE SURROUNDED WITH ORDINARY,  
YOU CHOSE TO BE THE EXTRA.  
WHEN THE WORLD WAS RUNNING,  
YOU CHOSE TO FLY AND OPEN NEW POSSIBILITIES,  
AVENUES AND OPPORTUNITIES THAT  
ADDED WINGS TO YOUR GROWTH.

KUKREJA GROUP NOW  
INVITES YOU TO STEP-IN TO  
SUCH AN ASPIRED LIVING.

PRESENTING KUKREJA 'CLASSIC' -  
A LIFESTYLE BEYOND ORDINARY THAT ALLOWS  
YOU TO ELEVATE YOURSELF IN EVERY POSSIBLE MANNER,  
BY ADDING WINGS TO YOUR LIFE.





# RESIDENTIAL HAVEN WITH WINGS

TO LET YOU LOOK BEYOND THE OBVIOUS



2 BHK TERRACE BALCONY RESIDENCES THAT  
ELEVATE 'LIFE'

# KUKREJA CLASSIC

OFF PALM BEACH ROAD, SANPADA

COME HOME TO 'KUKREJA CLASSIC'.  
ADD WINGS TO  
DIVERSE FACETS OF YOUR LIFE.

WELCOME TO SPACIOUS APARTMENTS WITH TERRACE BALCONIES THAT ALLOW YOU TO BECOME ONE WITH THE CLOUDS, THE BIRDS & YOURSELF; INDULGE IN GRAND RECREATIONS ON LEVEL 4 WITH A HOST OF LEISURE AVENUES THAT TAKE YOUR IMAGINATION TO A NEW LEVEL; EMBRACE COMFORTS IN A WELL-CONNECTED LOCATION THAT LETS YOU FLY-AWAY TO ANY PART OF THE CITY, FAST. JUST AS IF, YOU HAD WINGS.

SO COME ABOARD TO A NEW WAY OF LIFE. EMBRACE A LIVING WHERE YOUR LIFE GETS WINGS.

#### PROJECT HIGHLIGHTS

- 4 MAGNIFICENT TOWERS OF 21 STOREYS
- SPACIOUS & COMPACT 2 BHK RESIDENCES WITH TERRACE BALCONIES
- LAVISH CAR PARKS ACROSS GROUND + 3 LEVELS
- EXTRAVAGANT PODIUM WITH RECREATIONAL AVENUES ON LEVEL 4
- FIRST HABITABLE FLOOR BEGINS FROM 5<sup>TH</sup> LEVEL
- CONVENIENTLY LOCATED OFF PALM BEACH ROAD



Image for Representation purpose only



LIFESTYLE THAT ADDS WINGS  
TO YOUR IMAGINATION

BY LETTING YOU BECOME ONE WITH THE CLOUDS & BIRDS



ENDLESS OPEN VIEWS & CITYSCAPES FROM  
MOST APARTMENTS



Image for Representation purpose only



PRIVILEGES THAT GIVE YOU WINGS  
TO LAUGH, RELAX & REJUVENATE WITHIN THE PREMISE ITSELF



RECREATIONS ON LEVEL 4, THAT LET YOU  
'JUST WING IT'

INDULGE IN WEEKEND ESCAPADES  
EVEN ON WEEKDAYS  
DESIGNER PODIUM WITH CURATED INDULGENCES



# A LIFESTYLE ZONE FOR OUR PRIVILEGED RESIDENTS

A HOST OF LEISURE AVENUES ON LEVEL 4



SWIMMING POOL



KIDS' POOL



SUNDECK



PERGOLA



BARBEQUE CORNER



LANDSCAPED PARTY LAWN



GYM



LANDSCAPED GARDEN



LANDSCAPED VERTICAL GARDEN



JOGGING TRACK



CYCLING TRACK



CHILDREN'S PLAY AREA



OPEN RECREATIONAL AREA



BASKET BALL COURT





PROJECT LAID IN A  
PRIME LOCALE WINGED WITH

DIVERSE MODES OF TRAVEL



NESTLED IN A WELL-CONNECTED LOCATION  
OFF PALM BEACH ROAD

A PRIME LOCATION  
SURROUNDED BY CONVENIENCES GALORE

OFF PALM BEACH ROAD, SANPADA

LOCATION MAP



CONNECTIVITY:

- VASHI & SANPADA RAILWAY STATIONS - 3 MINS
- VASHI BUS DEPOT - 5 MINS
- PROPOSED AIRPORT - 20 MINS
- AIROLI - 20 MINS
- CHEMBUR - 20 MINS



MAJOR ATTRACTIONS:

- FORTIS HIRANANDANI, MGM, WOCKHARDT IN THE VICINITY
- FATHER AGNELS, SADHU VASWANI, RYAN INTERNATIONAL SCHOOL CLOSE BY
- CENTER ONE, RAGHULEELA, INORBIT MALL JUST A FEW MINUTES AWAY
- SURROUNDED BY FINE DINES, LOUNGES & FAST FOOD JOINTS
- VERY CLOSE TO MAJOR ENTERTAINMENT VENUES & HAPPENING ZONES



# KUKREJA CLASSIC

OFF PALM BEACH ROAD, SANPADA



Artist's Impression

# TYPICAL FLOOR PLAN - TOWER B

(6<sup>TH</sup>, 8<sup>TH</sup>, 10<sup>TH</sup>, 12<sup>TH</sup>, 14<sup>TH</sup>, 16<sup>TH</sup>, 18<sup>TH</sup> & 20<sup>TH</sup>)



# TYPICAL FLOOR PLAN - TOWER B

(5<sup>TH</sup>, 9<sup>TH</sup>, 13<sup>TH</sup>, 17<sup>TH</sup> & 21<sup>ST</sup>)



# TYPICAL FLOOR PLAN - TOWER C

(6<sup>TH</sup>, 8<sup>TH</sup>, 10<sup>TH</sup>, 12<sup>TH</sup>, 14<sup>TH</sup>, 16<sup>TH</sup>, 18<sup>TH</sup> & 20<sup>TH</sup>)

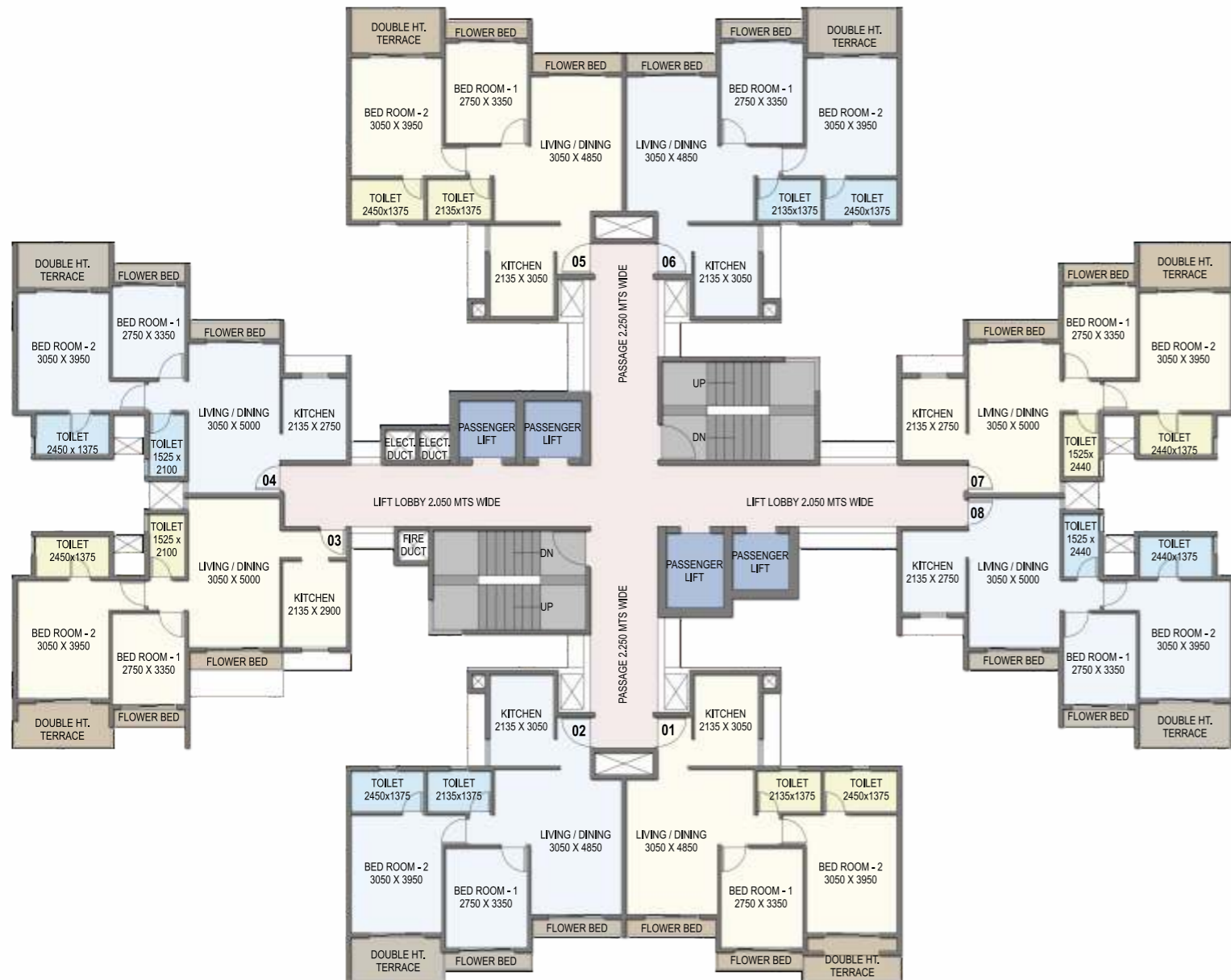

# TYPICAL FLOOR PLAN - TOWER C

(5<sup>TH</sup>, 9<sup>TH</sup>, 13<sup>TH</sup>, 17<sup>TH</sup> & 21<sup>ST</sup>)

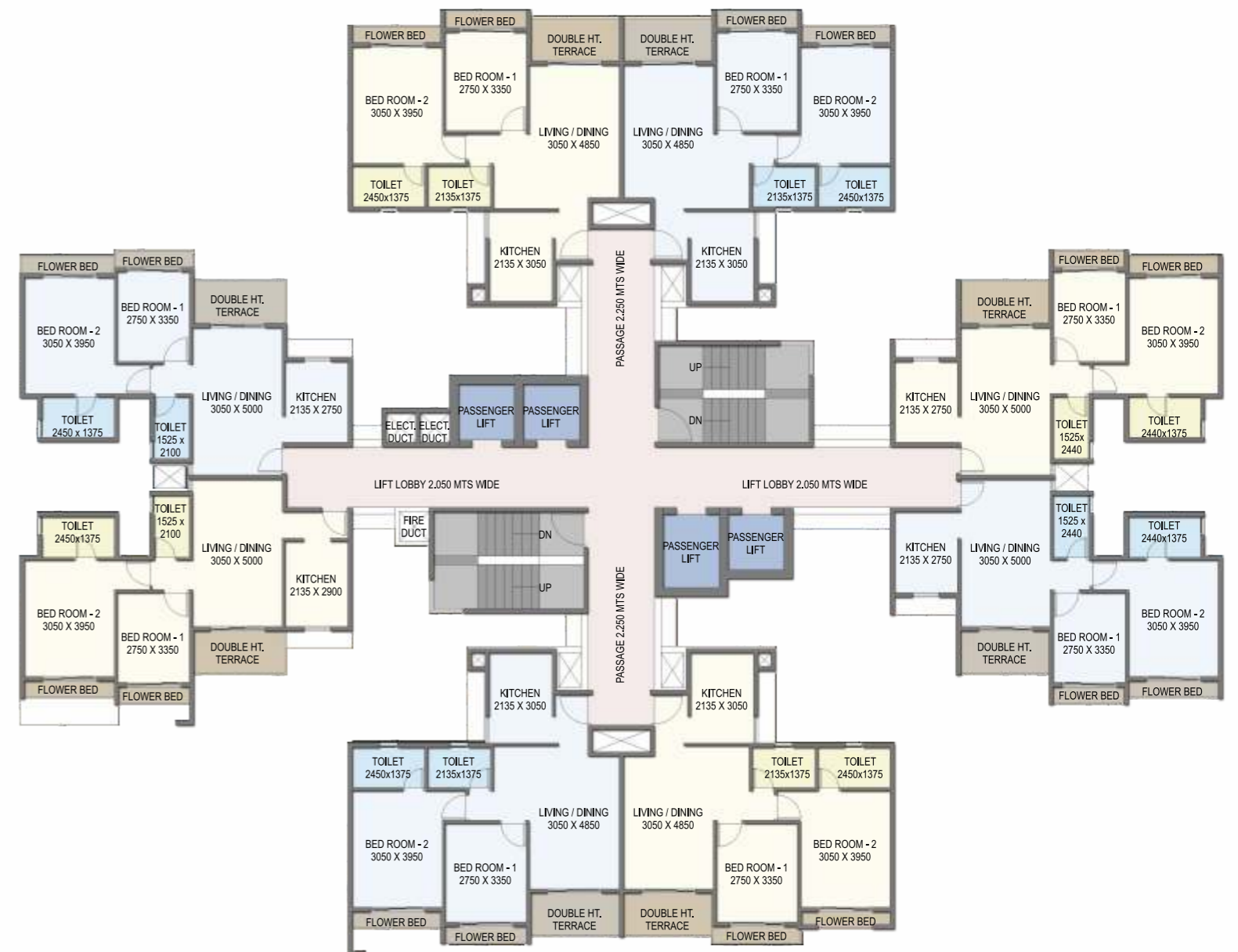

# TYPICAL FLOOR PLAN - TOWER D

(6<sup>TH</sup>, 8<sup>TH</sup>, 10<sup>TH</sup>, 12<sup>TH</sup>, 14<sup>TH</sup>, 16<sup>TH</sup>, 18<sup>TH</sup> & 20<sup>TH</sup>)



# TYPICAL FLOOR PLAN - TOWER D

(5<sup>TH</sup>, 9<sup>TH</sup>, 13<sup>TH</sup>, 17<sup>TH</sup> & 21<sup>ST</sup>)

